



Model W1750 Bandsaw Stand Instruction Sheet

Introduction

Your new Model W1750 Bandsaw Stand (Figure 1) is designed for use with the Model W1749 9" Bandsaw.

Inventory (Figure 2)

	Qty
A. Long Top Brackets.....	2
B. Short Top Brackets.....	2
C. Long Bottom Brackets.....	2
D. Short Bottom Brackets.....	2
E. Stand legs.....	4

Hardware Bag (Not Shown)

- Carriage Bolts $\frac{5}{16}$ "-18 x $1\frac{1}{2}$ " 16
- Hex Bolts $\frac{5}{16}$ "-18 x $1\frac{3}{4}$ " 4
- Hex Nuts $\frac{5}{16}$ "-18..... 20
- Flat Washers $\frac{5}{16}$ "..... 24

Specifications

- Overall Size..... $21\frac{1}{2}$ " W x $27\frac{3}{4}$ " L x $27\frac{1}{4}$ " H
- Weight..... 12 lbs

Assembly

We recommend assembling the stand upside down. To make it easier, have an assistant hold the pieces while you assemble the stand.

NOTICE

Do not final tighten stand bolts until all components have been assembled.

To assemble the stand, do these steps:

1. Mount a long top and bottom bracket to a stand leg and loosely secure with two $\frac{5}{16}$ "-18 x $1\frac{1}{2}$ " carriage bolts, flat washers, and hex nuts as shown in Figure 3.



Figure 1. Model W1750.

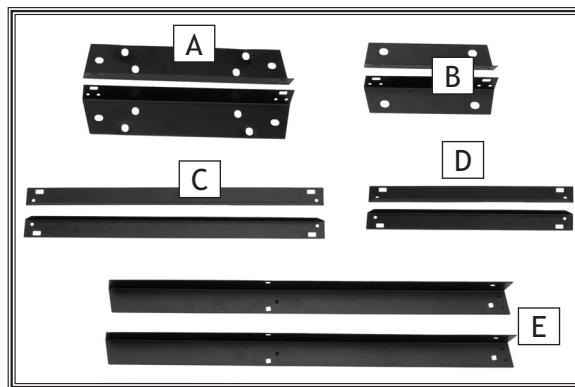

Figure 2. Model W1750 Inventory.

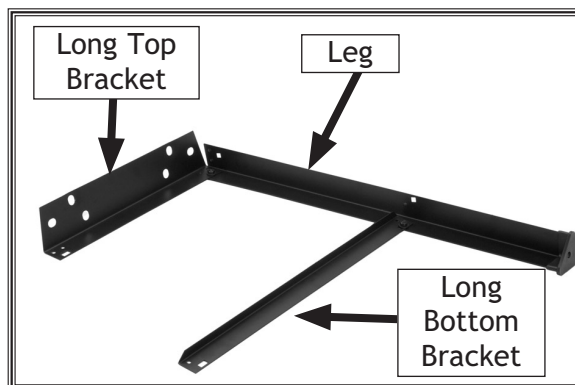

Figure 3. Top and bottom long brackets secured to a stand leg.

2. Secure a second leg to the long top and bottom brackets with two $\frac{5}{16}$ "-18 x $\frac{1}{2}$ " carriage bolts, flat washers and hex nuts as shown in **Figure 4**.
3. Repeat **Steps 1-2** to build another leg assembly.
4. Secure the short top and bottom brackets to one of the leg assemblies as shown in **Figure 5** with four $\frac{5}{16}$ "-18 x $\frac{1}{2}$ " carriage bolts, flat washers, and hex nuts.
5. Fasten the stand assembly to the other leg assembly and secure with the remaining fasteners (**Figure 6**).
6. Turn the stand upright and adjust it so the legs are evenly positioned, then tighten all the stand fasteners.

Mounting

To mount the stand to the bandsaw, do these steps:

1. Align the four holes on the bottom of the Model W1749 with the corresponding holes on the Model W1750 top.
2. Using two 12mm open-end wrenches, secure the stand to the bandsaw with four $\frac{5}{16}$ "-18 x $1\frac{3}{4}$ " hex bolts, four hex nuts, and eight $\frac{5}{16}$ " flat washers as shown in **Figure 7**.

Customer Service

For questions contact Woodstock International Technical Support at (360) 734-3482, or send e-mail to: tech-support@woodstockint.com.

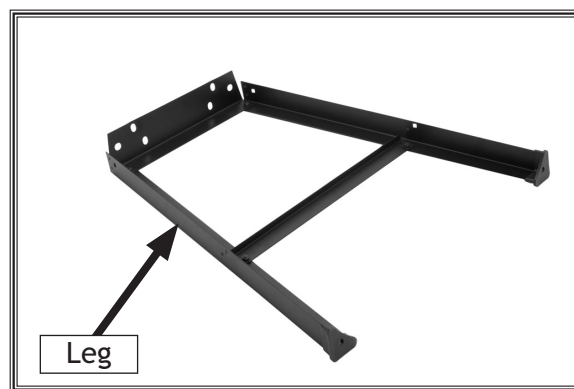

Figure 4. A completed leg assembly.

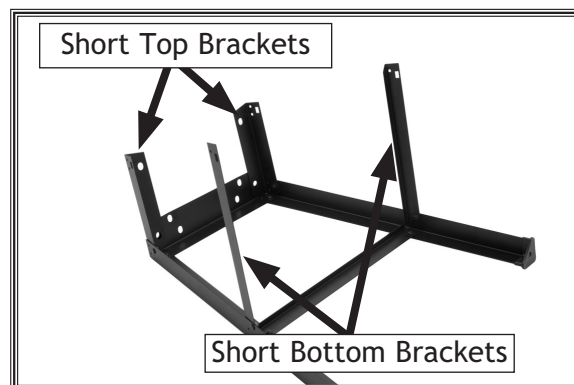

Figure 5. Short top and bottom brackets secured to a leg assembly.



Figure 6. Completed stand assembly.

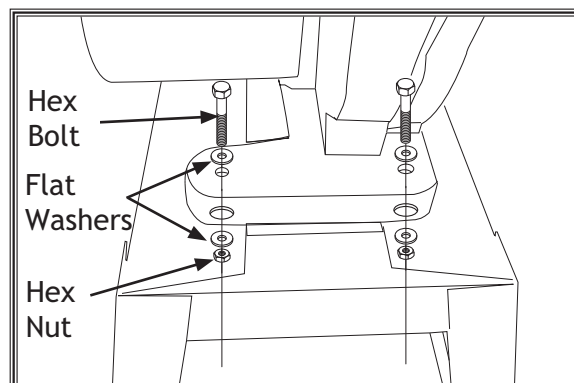
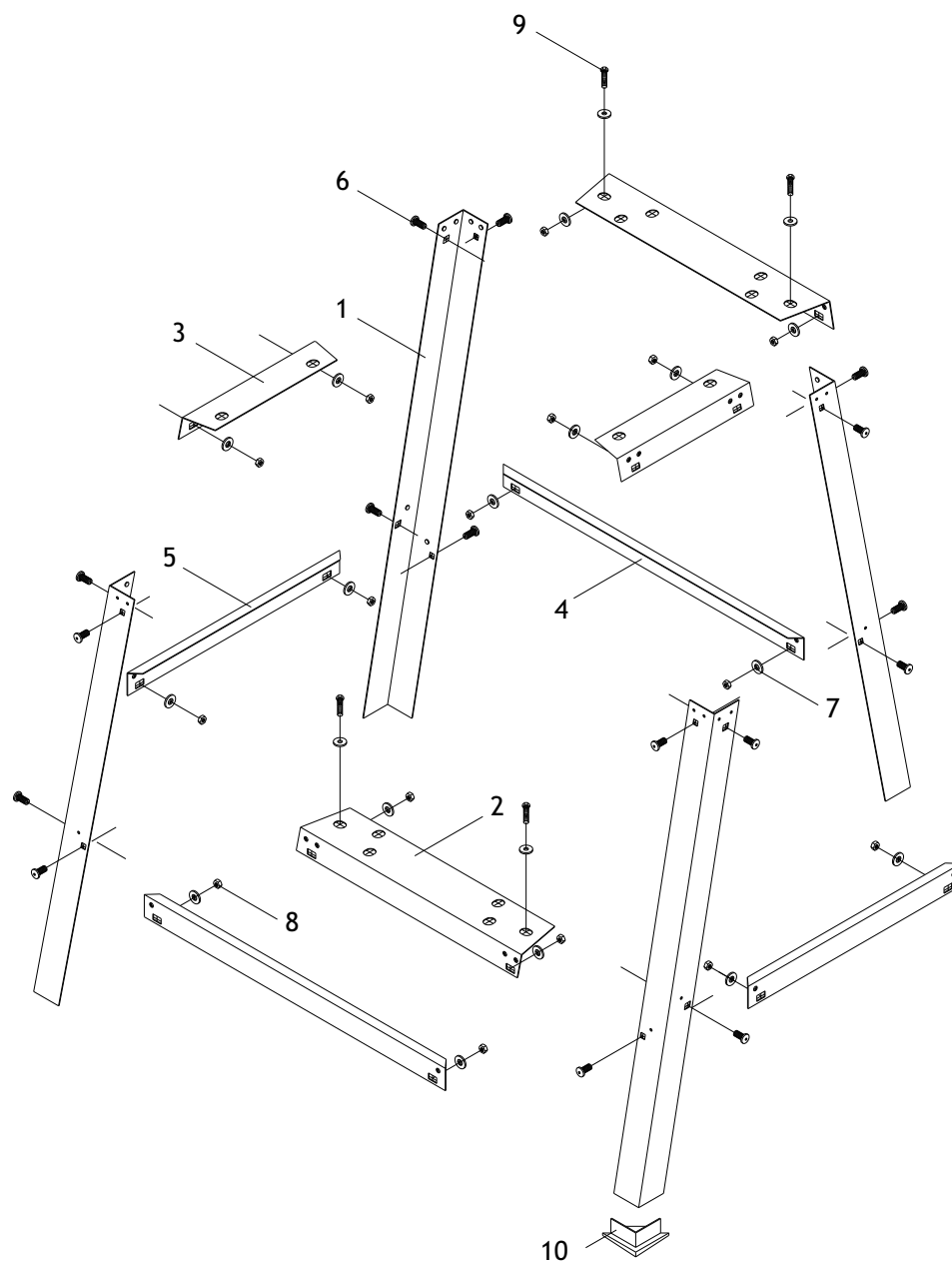

Figure 7. Mounting Model W1749 bandsaw to W1750 stand (2 mounting holes shown).



REF	PART #	DESCRIPTION
1	X1750001	LEG
2	X1750002	LONG TOP BRACKET
3	X1750003	SHORT TOP BRACKET
4	X1750004	LONG BOTTOM BRACKET
5	X1750005	SHORT BOTTOM BRACKET
6	XPCB02	CARRIAGE BOLT 5/16-18 X 1/2
7	XPW07	FLAT WASHER 5/16
8	XPN02	HEX NUT 5/16-18
9	XPB22	HEX BOLT 5/16-18 X 1-3/4
10	X1750010	FOOT PAD 45MM

COPYRIGHT © MAY, 2006 BY WOODSTOCK INTERNATIONAL, INC.

**WARNING: NO PORTION OF THIS MANUAL MAY BE REPRODUCED IN ANY SHAPE OR FORM WITHOUT
THE WRITTEN APPROVAL OF WOODSTOCK INTERNATIONAL, INC.**

#8198BL

Printed in China

